



District of Sicamous

Fees and Charges Bylaw No. 740, 2009

Effective Date – January 28, 2009

Consolidated for Convenience Only

This is a consolidated version of the parent bylaw that incorporates changes made pursuant to the following amendment bylaws:

Amendment Bylaw	Effective Date
Bylaw No. 745, 2009	April 8, 2009
Bylaw No. 748, 2009	May 13, 2009
Bylaw No. 758, 2009	July 22, 2009
Bylaw No. 766, 2009	October 28, 2009
Bylaw No. 767, 2009	October 28, 2009
Bylaw No. 768, 2009	October 28, 2009
Bylaw No. 769, 2009	October 28, 2009
Bylaw No. 771, 2009	October 28, 2009
Bylaw No. 787, 2010	April 14, 2010
Bylaw No. 796, 2010	May 26, 2010
Bylaw No. 798, 2010	July 28, 2010
Bylaw No. 800, 2010	October 27, 2010
Bylaw No. 809, 2011	February 9, 2011
Bylaw No. 818, 2011	June 8, 2011
Bylaw No. 824, 2011	July 13, 2011
Bylaw No. 833, 2011	November 9, 2011
Bylaw No. 846, 2012	July 11, 2012
Bylaw No. 865, 2013	October 23, 2013
Bylaw No. 868, 2013	January 22, 2014
Bylaw No. 877, 2014	April 9, 2014
Bylaw No. 884, 2014	December 10, 2014
Bylaw No. 911, 2016	May 25, 2016
Bylaw No. 912, 2016	June 8, 2016
Bylaw No. 923, 2016	December 13, 2016
Bylaw No. 924, 2016	January 11, 2017
Bylaw No. 929, 2017	March 8, 2017
Bylaw No. 938, 2017	December 13, 2017
Bylaw No. 942, 2018	February 14, 2018
Bylaw No. 956, 2019	January 30, 2019
Bylaw No. 959, 2019	February 13, 2019
Bylaw No. 970, 2019	September 11, 2019
Bylaw No. 980, 2020	February 12, 2020
Bylaw No. 984, 2020	June 10, 2020
Bylaw No. 993, 2021	January 27, 2021
Bylaw No. 1005, 2021	May 26, 2021

This consolidation is for convenience and reference purposes only. Persons making use of this consolidated version of Bylaw No. 740 are advised that it is not a legal document. For the purposes of interpreting and applying the law, the original Bylaw No. 740 and all amending bylaws must be consulted.

DISTRICT OF SICAMOUS

BYLAW NO. 740

A Bylaw to establish fees and charges for various District services.

WHEREAS Section 194 of the Community Charter provides that Council may, by bylaw, establish fees and charges for various District services;

NOW THEREFORE the Council of the District of Sicamous, in open meeting assembled, **ENACTS AS FOLLOWS:**

1. There is hereby established fees and charges for the District services as set out in Schedule "A" attached hereto and forming part of this bylaw.
2. This bylaw may be cited as the ***"District of Sicamous Fees and Charges Bylaw No. 740, 2009"***.

READ a first time this 14th day of January, 2009.

READ a second time this 14th day of January, 2009.

READ a third time this 14th day of January, 2009.

RECONSIDERED AND FINALLY ADOPTED this 28th day of January, 2009.

"Malcolm MacLeod"
Mayor

"Alan L. Harris"
Clerk

Certified a true and correct copy of the District of Sicamous
Fees and Charges Bylaw No. 740, 2009.

Clerk

Schedule A
 attached to and forming part of Bylaw No. 740, 2009

PART 1 – WATER AND SEWER RATES (Amending Bylaw No. 956, 2019)

WATER RATES

Turn On/Off Fees:

Where water service connections have been installed by the property owner and inspected to District approval, a turn on service fee of \$20.00 for each occurrence of turning the water service “on” or “off” will be charged. When water turn on/off is requested after normal business hours, charges will be assessed as per the “emergency call out rate”.

Inspections:

Where a connection is to be made to the waterworks system, an inspection charge of \$60.00 shall be levied upon issuance of a building permit, or prior to signature of a plan of subdivision, or prior to turning on the water service as the case may be. Where the District is requested to turn on the water service at the same time as the required inspection is carried out, the water service turn on fee may be waived.

Connection Charges:

Where a water service connection has not been provided to the property and a water service is requested to be provided by the District, the following service connection fees shall be charged to the property owner for the provision of:

19 mm (3/4”) water service connection	\$ 1,550.00
25 mm (1”) water service connection	1,625.00
38 mm (1 ½”) water service connection	1,900.00
50 mm (2”) water service connection	2,200.00
Over 2” water service connection	Varies by size and related costs

Connections provided to the property and paid by the District or the Developer on an extension of the water system will pay the above connection charges.

In addition to the foregoing charges, the cost, as estimated by the District, for road crossing cuts or borings as required to provide the water service connection, shall be charged to the property owner.

In addition to the foregoing charges, the District will add an administration fee of 10% of the estimated costs for the work to the charges payable by the property owner.

The property owner shall pay to the District, the total estimated charges for the work prior to the issuance of a Building Permit or commencement of the work, whichever is the earliest.

In circumstances where the properties water service connection benefits the District’s waterworks system, and the connection is encouraged by the District, the water service connection fee will be fully waived. These properties have been identified in PART 1 - Appendix A.

Water usage will be charged as follows:**PART 1 – WATER AND SEWER RATES****WATER RATES****Water usage will be charged as follows:****A. Metered Properties**

Meters are read and billed semi-annually. There is a fixed fee which varies depending on meter size plus a charge for each cubic meter of water consumed. In addition, all stratified properties have a per unit fee. The following table summarizes the semi-annual rates from 2019 to 2023.

Charges	2019	2020	2021	2022	2023
¾ inch – fixed fee	130.00	130.00	130.00	130.00	130.00
1 inch – fixed fee	250.00	250.00	250.00	250.00	250.00
1 ½ inch – fixed fee	700.00	700.00	700.00	700.00	700.00
2 inch – fixed fee	1,200.00	1,200.00	1,200.00	1,200.00	1,200.00
3 inch – fixed fee	2,900.00	2,900.00	2,900.00	2,900.00	2,900.00
4 inch – fixed fee	5,300.00	5,300.00	5,300.00	5,300.00	5,300.00
Stratified property per unit charge	45.00	*50.00	55.00	60.00	65.00
Per cubic meter of water consumed	0.60	0.70	0.80	0.90	1.00

** this charge will be prorated based on permitted continuous occupancy as defined within the District of Sicamous Zoning Bylaw.*

B. Non Metered Properties – Flat Rate Effective January 1st, 2019

Properties without a meter are billed annually. The following table summarizes the annual rates from 2019 to 2023.

Charges	2019	2020	2021	2022	2023
Residential	725.00	740.00	754.00	769.00	784.00
Commercial	1,400.00	1,428.00	1,456.00	1,485.00	1,514.00
Per houseboat charge	20.00	20.00	20.00	20.00	20.00

SEWER RATES**Connection Fees:**

Inspection Fee - \$60.00

Additional Sewer Service Connection - Actual cost plus a 10% administrative fee

New Sewer Service Connection - \$4,500.00

Sewer usage will be charged as follows:**A. Water Metered Properties**

Water meters are read semi-annually and the sewer billing based on water consumption and meter size is billed accordingly. There is a fixed fee which varies depending on the water meter size plus a charge for 80% of each cubic meter of water consumed. In addition, all stratified properties have a per unit fee. The following table summarizes the semi-annual rates from 2019 to 2023.

Charges	2019	2020	2021	2022	2023
¾ inch – fixed fee	100.00	100.00	100.00	100.00	100.00
1 inch – fixed fee	110.00	110.00	110.00	110.00	110.00
1 ½ inch – fixed fee	120.00	120.00	120.00	120.00	120.00
2 inch – fixed fee	200.00	200.00	200.00	200.00	200.00
3 inch – fixed fee	400.00	400.00	400.00	400.00	400.00
4 inch – fixed fee	500.00	500.00	500.00	500.00	500.00
Stratified property per unit charge	140.00	*140.00	140.00	140.00	140.00
Per cubic meter of water consumed (80%)	0.80	0.85	0.90	0.925	0.95
Non-compliant: East of Narrows	914.00	914.00	914.00	914.00	914.00
Non-compliant: West of Narrows	457.00	914.00	914.00	914.00	914.00

** this charge will be prorated based on permitted continuous occupancy as defined within the District of
Sicamous Zoning Bylaw.*

All metered users shall be charged for use of the sanitary sewer system on the basis of the quantity of water discharged into the system. The quantity of water discharged is deemed to be eighty percent (80%) of the water delivered to the real property by the municipal waterworks system.

A user of the sanitary sewer system who establishes (at their cost), to the satisfaction of the District, that the discharge into the system is less than eighty percent (80%) of the water delivered by the municipal waterworks system to their parcel of real property, shall have the user charge reduced corresponding to the actual quantity of discharge.

B. Non Metered Properties – Flat Rate Effective January 1st, 2019

Properties with no water meter or no water service are billed annually. The following table summarizes the annual rates from 2019 to 2023.

Charges	2019	2020	2021	2022	2023
Residential	490.00	499.00	509.00	519.00	529.00
Commercial	1,120.00	1,142.00	1,164.00	1,187.00	1,210.00
Non-compliant: East of Narrows	1,828.00	1,828.00	1,828.00	1,828.00	1,828.00
Non-Compliant: West of Narrows	914.00	1,828.00	1,828.00	1,828.00	1,828.00

C. Sewer Metered Properties Effective January 1st, 2019

Properties with a marina sani-dump and sewer meter will be billed semi-annually. There is a fixed fee plus a charge for each cubic meter of waste. The semi-annual rates are as follows:

Fixed fee:	\$ 500.00
Per cubic meter charge:	\$ 7.20

D. Trucked Waste Effective January 1st, 2019

All trucked waste discharged into the sanitary sewer system at the Wastewater Treatment Facility shall be transported by only those holding a current and subsisting District of Sicamous Business License, and shall comply with all articles listed under Section 6 of this bylaw.

Applications for License of Agreements for access to the site after regular District working hours are subject to Council approval. The District of Sicamous reserves the right to accept or reject any/all applications and to specify the terms of the License as deemed appropriate and necessary.

For trucked waste discharged in the sewer system, the licensed firm shall be charged a rate of \$ 22.50 per cubic meter of waste generated within the District and Area E.

Surcharge for High Strength Waste

At the discretion of the District, any user of the sewer system who uses more than 5% of the maximum daily capacity of the sewer system, the District reserves the right, in addition to charges according to volume of waste discharge, to levy monthly charges for excessive concentrations of B.O.D's, and/or suspended solids, and/or phosphorous.

In the event that the B.O.D.₅ exceeds 250 mg/L, and/or the suspended solids exceeds 250 mg/L, and/or the phosphorus exceed 8 mg/L the user will be charged on a monthly basis according to the following formula:

$$R_s = (B.O.D._5/250 \times \$0.40 + SS/250 \times \$0.30 + P/8 \times \$0.30 - \$1.00)$$

where

R_B = the base rate paid by all metered users regardless of the strength of their waste

R_s = the surcharge rate per 1,000 litres to be charged monthly in addition to the base rate above

B.O.D.₅ = the concentration of biochemical oxygen demand in milligrams per litre as determined by Standard Methods or 250 mg/L, whichever is greater

SS = the concentration of suspended solids in milligrams per litre as determined by Standard Methods or 250 mg/L, whichever is greater

P = the concentration of phosphorus in milligrams per litre as determined by Standard Methods or 8 mg/L, whichever is greater.

For the purpose of calculation of RS above, the highest value of B.O.D.₅ and SS and P found in any month will be used for the subsequent month(s).

Additional Provisions:

1. A penalty of ten percent (10%) will be imposed on all “flat rate” consumers, on any balance of water and sewer rates remaining unpaid after the first day of July of the current year.
2. A penalty of 1% per month shall be charged on all metered billings outstanding after thirty (30) days.
3. Water and sewer rates for the current year remaining unpaid after the thirty-first (31st) day of December of that year shall be deemed to be taxes in arrears and shall forthwith be entered on the real property tax roll by the Collector as taxes in arrears against the property to which the water rates apply
4. The owner of a real property located on the East or West side of the Sicamous Narrows not connected to the sanitary sewer system by the connection deadline as specified within the District of Sicamous Sewer Rates and Regulation Bylaw No. 194, 1996 as amended from time to time will pay an annual non-compliant rate.
5. Upon installation and inspection of a meter, the flat rate charge will be credited for the remaining months of the year and the meter rate will be billed from that date forward; and the minimum meter charge will be based on a combination of both the flat and meter charges for the year in which the meter was installed and inspected and effective January 1st of the following year, property owners will be billed based on meter rates only.
6. Emergency call out rates are a minimum of \$175.00, which covers 2 hours. Any additional time will be charged at \$90.00 per hour.

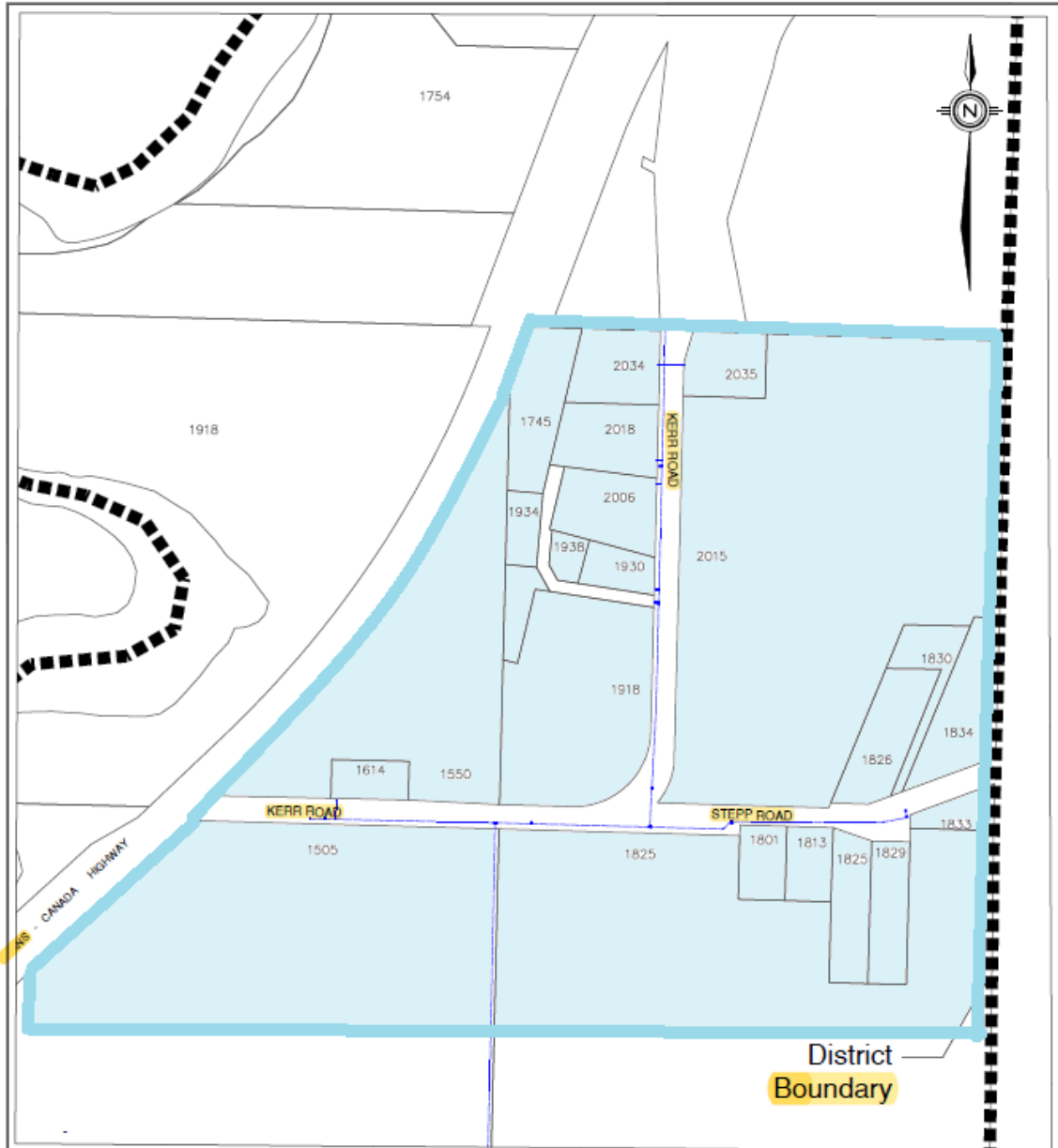

Scale: NTS		Water Connection Fee Exemption Area Kerr Road and Stepp Pit Road Bylaw No. 740 2019 All Properties Marked within Blue Area	
DRAWN BY JJS			
DATE JAN 2019			
ACAD FILE	DISTRICT-BASE		
REV.	DRAWING No.		
0	Part 1, Appendix A		

PART 2 – ADMINISTRATIVE FEES (Amending Bylaw No. 884, 2014)

Effective January 1st, 2015, the following Administrative Rates apply:

(a) Bylaws:

Photocopying or reproduction costs pursuant to Section 194 (2) of the Community Charter Act:

- (i) 8 ½ x 11: \$0.50 per copy per page or \$0.65 per copy for double sided copies.
- (ii) 8 ½ x 14: \$0.50 per copy per page or \$0.65 per copy for double sided copies.
- (iii) 11 x 17: \$0.75 per copy per page or \$0.90 per copy for double sided copies.
- (iv) Bylaw in binder form reproduced at printing office – Actual cost.
- (v) Facsimile copies: \$1.00 per page local
\$2.00 per page long distance (maximum number of pages per fax = 5)

Regulatory Bylaws (Consolidated):

- | | |
|---|---------|
| (i) Zoning Bylaw (Text and Maps) | \$25.00 |
| (ii) Zoning Bylaw (Text only) | \$20.00 |
| (iii) Official Community Plan (Text and Maps) | \$35.00 |
| (iv) Official Community Plan (Text only) | \$20.00 |
| (v) Subdivision & Servicing Bylaw | \$25.00 |
| (vi) Building and Plumbing Regulatory Bylaw | \$10.00 |

(b) Minutes:

Photocopying or reproduction costs pursuant to Section 194 (2) of the Community Charter Act and the District of Sicamous Procedures Bylaw No. 380, 2000.

- (i) Copies of Minutes \$0.50 per copy per page or
\$0.75 per copy per page for double sided
- (ii) Facsimile copies \$1.00 per page local or
\$2.00 per page long distance
(maximum number of pages per fax = 5)

(c) Property Tax Certificates:

- | | |
|---------------------------------------|--|
| (i) Property Tax Certificates | \$35.00 per parcel |
| (ii) Tax Certificates (via BC Online) | \$20.00 per parcel |
| (iii) Facsimile copies | \$1.00 per page local or
\$2.00 per page long distance. |

(d) Reports:

- (i) Building Permits Monthly Printout \$0.50 per page

- (e) **Municipal Maps:**
- | | | |
|-------|----------------------------|--------------------------|
| (i) | District Boundary Maps | \$12.00 plus GST and PST |
| (ii) | Property Maps: | |
| | 8 ½ x 11 | \$0.50 per page |
| | 8 ½ x 14 | \$0.50 per page |
| | 11 x 17 | \$1.00 per page |
| (iii) | Areal Maps | |
| | Full Size Colour Laminated | \$30.00 |
| | Half Size Colour Laminated | \$20.00 |
- (f) **Land Title Charges:**
- | | | |
|-----|--|---------|
| (i) | Land Titles Registry* | \$20.00 |
| | *For the registered property owner or his/her agent only | |
- (g) **Access Permits:**
- | | | |
|------|---|---------|
| (i) | Non-refundable permit fee for the first application | \$50.00 |
| (ii) | Each additional application | \$25.00 |
- (h) **NSF Cheques:**
 If a cheque in payment of municipal taxes, water or sewer utility invoices, or any amounts described in this bylaw, is returned from a financial institution marked “NSF”, an administration charge of \$25.00 is charged to that customer.
- (i) Where the fees prescribed herein are not paid within thirty (30) days when invoiced and presented, there will be a ten percent (10%) penalty attached thereto with further services as prescribed being discontinued until payment and penalties are paid.
- (j) **Fire Department Fees** *(Amending Bylaw No. 970, 2019)*
- Inspection Fees:**
- | | |
|---------------------------------|-----------|
| First Inspection | No Charge |
| Follow Up Inspection | No Charge |
| Second Follow Up Inspection | \$50.00 |
| Subsequent Follow Up Inspection | \$100.00 |
- Attendance at False Alarms:**
 Applicable to False Alarms occurring within the same 12 month period.
- | | |
|----------------------|-----------|
| First 3 False Alarms | No Charge |
| Fourth False Alarm | \$100.00 |
| Fifth False Alarm | \$150.00 |
- Fees to be Charged for Attendance at Outdoor Fires:**
 A person or property owner who starts a fire without a valid permit pursuant to Outdoor Burning Bylaw No. 452, 2002 as amended from time to time, shall be responsible for the costs of providing the additional personnel and equipment that the Fire Chief may deem necessary to extinguish the fire or to suppress any escape or threatened escape of the fire.
- | | |
|-----------------------|---|
| Equipment Hourly Rate | \$400.00 |
| Personnel | Remuneration as per Fire Fighter Remuneration Policy F-10 |
- (k) **Nuisance Properties**
- | | |
|--|------------------------|
| Nuisance Property Repeat Service Calls | \$50.00 per attendance |
|--|------------------------|

PART 3 – BUILDING PERMIT FEES (Amending Bylaw No. 884, 2014)

1. Building Permit Application Fees:

For the purpose of calculating the fee for *permits* under this Bylaw, the value of *construction* shall be the greater of either the total contract price for the *construction* including all subcontracts, or the value of *construction* as determined by the *Building Official* on the basis of plans, specifications and information available.

2. Building Permit Application Fees: Non-Refundable:

A non-refundable *building permit* application fee shall be in accordance with the following scale:

a. Residential	
Single and Two Family Residential Application	\$ 100.00
New factory built dwellings	100.00
Additions/alterations	50.00
b. Multi-Family, commercial, industrial, institutional	
New	200.00
Additions/alterations	100.00

3. Building Permit Fees and Charges:

a. <u>Based on Value:</u>	
i. For the first \$1,000 of construction value;	100.00
ii. For each additional \$1,000 of construction value or fraction thereof to \$1,000,000;	8.00
iii. For each additional \$1,000 of construction value greater than \$1,000,000	6.00
b. <u>For a Factory Built Home:</u>	
i. Installation;	200.00 plus
ii. For each \$1,000 of construction value of the works other than the value of the Factory Built Home.	8.00

4. Plumbing Permit Fees and Charges:

a. Minimum permit fee	100.00
b. <u>Plumbing Fixtures:</u>	
i. For the first three (3) plumbing fixtures:	100.00
ii. For each plumbing fixture thereafter	8.00
b. <u>Fire Suppression Sprinkler System:</u>	
i. For the first three (3) sprinkler heads:	100.00
ii. For each sprinkler head thereafter.	0.50
c. <u>Site services for Single and Two Family dwellings</u>	
i. Each District water service	100.00
ii. Each District sanitary sewer service	100.00
iii. Each District storm sewer service	100.00
d. <u>Site Services for other than Single and Two Family Dwellings</u>	
i. Minimum permit fee	100.00 plus
ii. Water service piping	\$1.50 per meter of length
iii. Sanitary sewer piping	\$1.50 per meter of length
iv. Storm sewer piping	\$1.50 per meter of length
v. Each catch basin, interceptor, drywell, sump	\$10.00 per fixture

5. Demolition/Moving Permit Fees and Charges:

- a. For a demolition or a moving permit 150.00

6. Permit Renewal:

Provided the original permitted building construction has continued and no charges to the permitted construction have occurred, the fee for such renewal shall be the greater of 25% of the original Building Permit fee or \$150.00.

7. Other Permit Fees and Charges:

- a. Re-Inspection Fee after the first re-inspection 90.00
- b. Masonry Chimney Permit 75.00
- c. Solid Fuel Fired Applicant Permit 75.00
- d. Public or Common Property Pool/Spa 500.00
- e. Administrative Charge to remove a "Notice on Title" 300.00
- f. Administrative Charge to remove a posted "Stop Work Notice" 150.00
- g. Special Inspection 150.00
- h. Special Inspection after hours Inspection Fee 300.00
- i. Specific Equivalency Report Administration Fee 150.00
- j. Land Title Search Fee *for registered property owner or agent 20.00

8. Building Permit Fee Reduction:

The Building Permit Fee calculated under Section 2 of this Schedule shall be reduced where:

- i. A Building Permit is issued for the construction of a complex building for which the Building Official requires professional design and has received complete Letters of Assurance; and
- ii. The Building Official issues to the owner, a Notice of Reliance upon the certification of the Registered Professionals that the design and plans submitted in support of the Building Permit Application comply with the BC Building Code and other applicable enactments relating to safety.

Where a Building Permit is issued under the foregoing Notice of Reliance, the Building Permit fee as calculated under Section 2 of this Schedule, shall be reduced by five percent (5%) to a maximum of \$500.00.

9. Double Permit Fees:

Where construction for which a permit is required by this Bylaw has been commenced prior to the issuance of a building permit, the applicant shall pay to the District double the fee prescribed in Appendix A, to a maximum of \$5,000.00.

10. Permit Fee Refund:

Where no construction has commenced within six (6) months of building permit issuance, should the permit holder apply in writing to cancel the permit, the Building Official may refund the permit fee less the greater of \$200.00 or fifty percent (50%) of such fee paid in respect to the building permit.

PART 4 – CEMETERY FEES

<u>DESCRIPTION</u>	<u>2009/2010</u>
<u>GRAVE SPACE (includes 25% Care Fund Contribution)</u>	
Adult	
(a) Resident	440.00
(b) Non-Resident	750.00
Child	
(a) Resident	400.00
(b) Non-Resident	640.00
Infant	
(a) Resident	100.00
(b) Non-Resident	200.00
Cremated	
(a) Resident	155.00
(b) Non-Resident	235.00
<u>Fees for Services: Open and Close</u>	
Adult	
(a) Burial	440.00
(b) Exhumation	880.00
Child	
(a) Burial	440.00
(b) Exhumation	880.00
Infant	
(a) Burial	335.00
(b) Exhumation	555.00
Cremated	
(a) Burial	220.00
(b) Exhumation	335.00
<u>Additional Service Charges:</u>	
After 3:30 p.m. on Weekdays, extra	220.00
Saturday, Sunday and Statutory Holidays – Coffin – extra	440.00
Saturday, Sunday and Statutory Holidays – Cremated Remains – extra	220.00
Transfer of License	36.00
Installation of Memorials (includes Care Fund Contribution of \$20.00)	100.00
<u>Goods:</u>	
Grave Liner – Adult	265.00
Grave Liner – Child	190.00
Flower Loops (includes installation)	60.00
Cremated Remains Vault	67.50

**** All rates plus GST***

PART 5 – BUSINESS LICENSE FEES**Classification:**

District of Sicamous Business Licence Fee, except mobile vendors	\$95.00
District of Sicamous Business Licence Fee, Mobile Vendors	\$190.00
Inter Community Business Licence (in addition to Business Licence)	\$150.00

Fees:

Business License Fees will be invoiced annually in December of the preceding year. Accounts are due and payable on or before January 31st of each year.

District of Sicamous Business Licence Fees issued for new businesses commencing after September 30 of a calendar year will be pro-rated 50%.

Inter Community Business Licence Fees will not be pro-rated.

NSF Cheques:

If a cheque in payment of a Business Licence Fee is returned to the District from a financial institution marked "NSF", an administrative charge of \$25.00 is added to that customer's account.

Delinquent Accounts:

Delinquent accounts, including NSF administrative charge, in arrears of 90 days will be forwarded to a Collection Agency for payment.

PART 6 – LAND USE FEES

Land Use Application:		Fee
1.	Application for amendment of the Official Community Plan.	\$ 700.00
1(a)	Submission of an Official Community Plan Amendment to a <i>Public Consultation Meeting</i>	250.00
2.	Application for amendment of the Zoning Bylaw.	700.00
3.	Single Submission of application to a Public Hearing. (OCP Amendment or Zoning Bylaw Amendment)	450.00
4.	Double Submission of application to a Public Hearing. (OCP and Zoning Bylaws Amendment)	550.00
5.	Application for a Housing Agreement.	200.00
6.	Administration and Inspection relating to Parking.	60.00
7.	Administration and Inspection relating to Drainage.	60.00
8.	Administration and Inspection relating to Signage.	60.00
9.	Administration and Inspection relating to Screening and Landscaping.	60.00
10.	Application to the Board of Variance.	200.00
11.	Application for a Development Variance Permit.	300.00
12.	Application for a Development Permit (No bylaw variances required).	300.00
13.	Application for a Development Permit (Requesting bylaw variances).	550.00
14.	Development Permit Extension Fee.	120.00
14(a)	Comprehensive Development Permit	500.00
15.	Application for a Temporary Commercial or Industrial Permit.	500.00
15(a)	Application for a Seasonal Temporary Use Permit	150.00
16.	Application for Conventional Subdivision – First Lot	450.00
	Conventional Subdivision – Each Additional Lot created.	100.00
17.	Application for a Strata Subdivision (Condominium Act).	450.00
	Strata Subdivision – Each Additional Lot created.	100.00
18.	Administration charge to discharge “Notice on Title”.	200.00
19.	Fee for Researching Property Status Inquiry.	60.00
20.	Contaminated Sites Profile	100.00
	NOTE: A Contaminated Sites Profile is required to be submitted with all Official Community Plan and Zoning Amendment applications, Development Variance Permit and Development Permit applications, Subdivision applications and Demolition Permit applications.	
21.	Rental of Development Notice Sign.	300.00
22.	Application for Latecomers Agreement.	1,000.00
23.	Agriculture Land Commission:	
	Exclusion (comprises ALC Fee of \$300.00 and District of Sicamous Fee of \$300.00)	600.00
	Subdivision or Use (comprises ALC Fee of \$300.00 and District of Sicamous Fee of \$300.00)	600.00
	Transportation and Utility Use (comprises ALC Fee of \$200.00 and District of Sicamous Fee of \$200.00)	400.00
24.	Application for the development of or replacement of a marina, docks, boat slips or berths:	
	Application Fee	300.00

PART 7 – SIGN FEES

1. Building Permit Application Fees - Non-Refundable.

(a)	Non-refundable signage permit application fee	\$50.00
(b)	For the first \$1,000.00 of completed value	\$50.00
(c)	For each additional \$1,000.00 or fraction thereof of completed value	\$ 7.00
2. For each re-inspection after the first recall inspection \$50.00
3. Special Inspection fee \$50.00

4. Signage Violation:

For all signs and signage structures, the value of completed construction and required site works used to determine the signage permit fees shall be calculated based on the declared construction value or the documented stipulated lump sum contract price, whichever is the greater.

The application fee paid may be credited to the permit fee payable for an approved permit provided there are no changes to the permit drawings and documentation submitted for approval after the application submission.

5. Installation of a sign without a Permit:

If any installation for which a permit is required by this Bylaw has been commenced prior to the issuance of a Sign Permit, the applicant shall pay to the District of Sicamous the applicable permit fees, and in addition, a penalty equivalent to the fees.

Part 8 – Recreation Program Fees

(Amending Bylaw No. 959, 2019)
 (Amending Bylaw No. 970, 2019)
 (Amending Bylaw No. 980, 2020)

Classes, Programs, Tournaments:	
<i>Rate is per class unless indicated otherwise.</i>	
After School Club (<i>Per Day</i>)	\$ 10
Home Alone Course	\$ 40
Babysitting Course	\$ 75
Learn to Paint	\$ 30
Generation Pound	\$ 75
Easter Hockey Tournament (<i>Per Team</i>)	\$ 1,150

Dance Classes:		
	Ages 4	Age 6 & Older
Break Dancing	\$ 100	\$ 150
Dance	\$ 75	\$ 80

Day Camp:		
Per Day	5 Day Pass	10 Day Pass
\$ 35	\$ 150	\$ 275

Pickleball:	
Drop In	10-Week Session
\$ 3	\$ 20

Swim Lessons:	
Infant – Age 4	Age 5 & Older
\$ 60	\$ 75

Tumbling:	
Ages 3 – 6	Age 6 & Older
\$ 70	\$ 80

Part 9 – Special Event Fees (Amending Bylaw No. 929, 2017)

Special Event Deposit	\$200
Special Event Permit (applicable only to events that include vendors)	
	per event
Commercial (gate fee)	\$300
Non-commercial (no gate fee)	\$150
Stage (within District of Sicamous boundaries)	
Damage deposit	\$2,000
Rental (includes deliver, set up, and tear down)	\$750 per event
Stage (outside District of Sicamous boundaries, within 90 km radius)	
Damage deposit	\$2,000
Rental (includes deliver, set up, and tear down)	\$1,750 per day
	\$2,500 per weekend (Friday, Saturday, Sunday)
Wash Car	
Damage deposit	\$2,000
Rental	\$1,000 per day
Special Event Mobile Vendor Permit	
	per event
Artisan Vendor (non-food)	\$20
Commercial Vendor	\$50
Food Vendor	\$100
Service Club	Free