

SCHEDULE

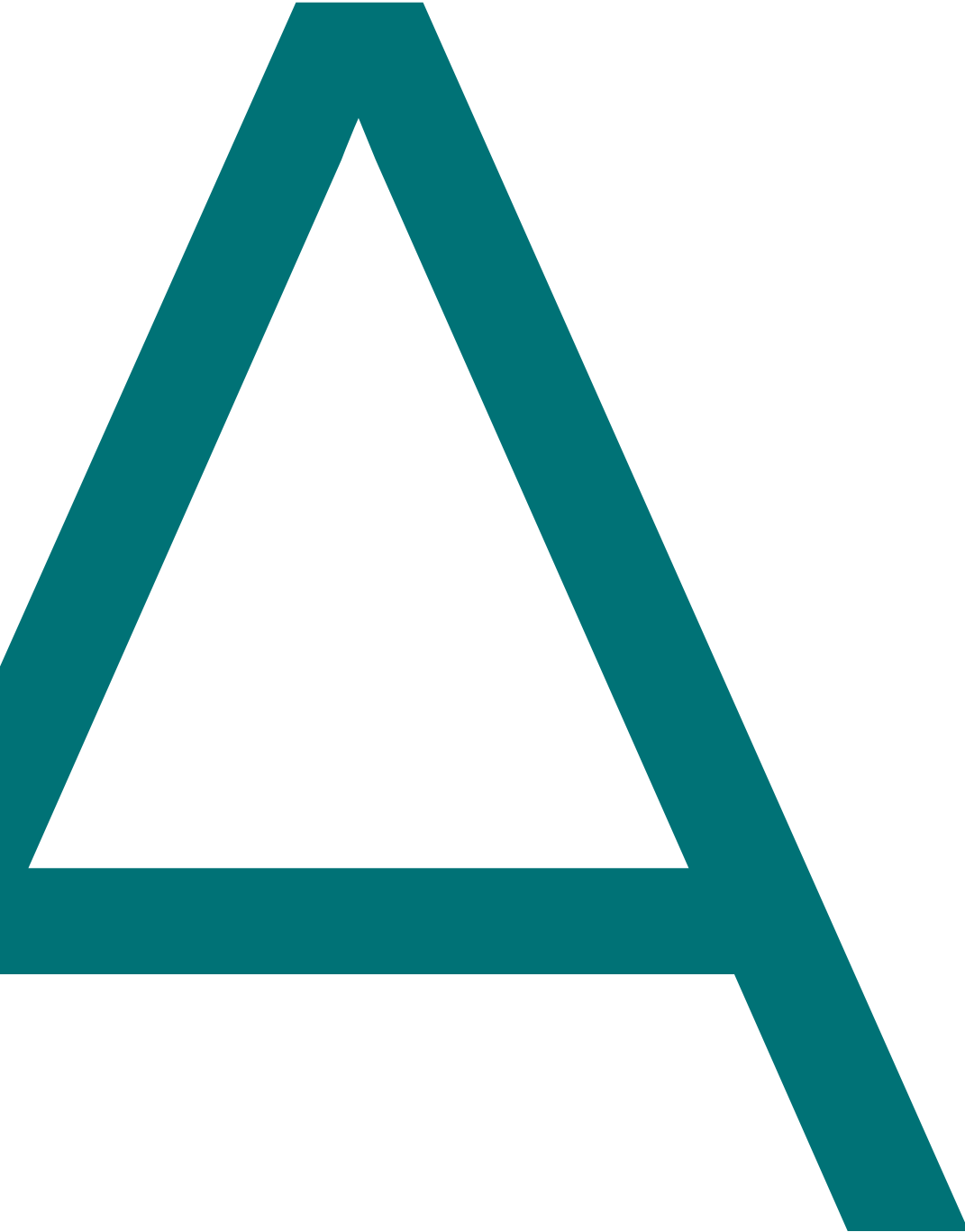

THIS PAGE LEFT INTENTIONALLY BLANK

PART ONE

THIS PAGE LEFT INTENTIONALLY BLANK

PART ONE - DEFINITIONS

1.1 Definitions

In this Bylaw, the following terms are defined:

Accessory Buildings & Structures means a Building or Structure that is subordinate to the Principal Building or use on a Parcel.

Accessory Use means a use that is normally incidental or associated with the Principal Use.

Agricultural Land Commission means the independent administrative tribunal of appointed Commissioners and staff who administer the Agricultural Land Reserve.

Agricultural Land Commission Act means the *Agricultural Land Commission Act* and its associated regulations.

Agricultural Land Reserve (ALR) means the Agricultural Land Reserve as defined within the *Agricultural Land Commission Act*.

Agriculture means growing, rearing, producing or harvesting livestock or agricultural crops and includes the processing on a parcel of the primary agricultural products harvested, reared or produced on that parcel and the use and storage of associated machinery, implements and agricultural supplies. Agriculture specifically excludes mushroom farm, intensive swine operation, intensive poultry production, feedlot, and cannabis production.

Agricultural Worker Accommodation means a Sleeping Unit Accessory to a Principle Agricultural Use intended for the temporary accommodation of an agricultural worker.

Agri-tourism Accommodation means a Sleeping Unit or Camping Space relates to an Agri-tourism Activity that is provided on the same a Parcel or farm unit.

Agri-tourism Activity means the use of agricultural Land for an activity that members of the public are invited to participate in including an agricultural heritage exhibit, a tour, an educational activity or demonstration, cart, sleigh or tractor rides, activities that promote or market livestock including shows and petting zoos, dog trials, harvest festivals or corn mazes.

Amenity Space means an indoor or outdoor space provided and specifically designed for use by occupants of a Residential Building for cultural, social and recreational activities, and except as specifically permitted by this bylaw, not used for commercial purposes. Such space may include community meeting space, guest accommodation, sports and fitness facilities, cultural facilities, artist studios, workshops, tennis courts, swimming pools, gardens, open space and children's play Structures and does not include areas used for Off-Street Parking, off-street loading, service driveways, private balconies, Decks or Patios or areas whose use is restricted by a conservation covenant granted to the District.

Animal Shelter means a facility providing Temporary care to household animals awaiting placement and specifically excludes breeding.

Approving Officer means the Approving Officer of the District of Sicamous.

Aquaculture means the growing and harvesting of plant or animal organisms in a natural or artificial aquatic situation that requires a body of water such as a pond, river, lake, estuary subject to provincial and federal regulations.

Archaeological Reserve means a place in which evidence of past cultural presence or significant activity is identified by a qualified archaeologist or First Nations expert, and preserved, and which has been, or may be, investigated using the discipline of archaeology and represents a part of the archaeological record.

Artist Studio means a Building, or portion thereof, used for the creation, display or sale of arts and crafts created onsite, the production of dance, live music, creative writing, painting, drawings, pottery or sculpture, video, moving or still photography, or other similar art forms, none of which involves amplified sound or one or more of the materials or processes that pose a risk to neighbouring properties.

Assembly means a use providing for the assembly of persons for religious, charitable, cultural, recreational, or private educational purposes and specifically includes Religious Institutions, auditoriums, youth centers, social halls, group camps, kindergartens, play schools, day nurseries, but specifically excludes Residential use and gaming and gambling facilities other than those operated on an occasional basis for charitable purposes.

Attainable Rental Unit means market housing that is affordable to households with a range of incomes, but most often at the low or moderate end of the scale and subject to a Housing Agreement as per Section 483 of the Local Government Act.

Auction means Buildings or Land used for the sale of new and used goods by means of a request or invitation for bids, including the Temporary storage of such goods and equipment, but does not include retail sales.

Awning means a retractable or non-retractable covering of non-rigid materials such as canvas or similar fabric projecting from the exterior wall of the Building.

Balcony means an unenclosed platform, attached to and projecting from the Building Face above the First Storey, normally surrounded by a balustrade or railing, and used as an outdoor porch or sun Deck with access only from within the Building.

Basement means an area 1.8 m or more in Height measured from the underside of the floor assembly above to the floor below which is buried between 1.0 m and 1.8 m below the average Grade level at the perimeter of the Building.

Batching Plant means the processing, manufacturing, recycling, and sales of concrete or the accessory manufacturing and sales of industrial products made from concrete or asphalt.

Bed & Breakfast means a Home Based Business that provides temporary accommodation within a Sleeping Unit, subject to the General Regulations.

Berth means a moorage space for a single vessel at a Dock, a Boat Lift, or a Private Moorage Buoy.

Biogas Energy Generation means a facility that produces biogas through the treatment of farm crops, organic waste or other biomass feedstock through a system of anaerobic digesters and supporting systems.

Boardwalk means a Structure designed to carry pedestrian and non-motorized traffic located on the foreshore and upland of the Natural Boundary of a Watercourse, except that it may be designed to afford emergency Vehicle use. Limited commercial and outdoor recreational activities may be permitted where zoning permits.

Boat Construction means the use of premises for the construction or repair of commercial or recreational boats and watercraft greater than 8 m in length.

Boat Launch means a Structure located on a shoreline to accommodate Vehicles or trailers for the purpose of launching and hauling boats out of the water.

Boat Lift means a mechanical device attached to a dock, used for the removal of boats from the water, and which can allow for a boat to be stored above the high-water level of the lake.

Boat Repair means the use of premises for the construction or repair of recreation boats and watercraft less than 8 m in length.

Boat Storage means the dry land storage of boats that are in working order and other marine equipment, associated with the operation of a marina, and does not include the dispensing of marine fuels or the servicing or major repair of boats or marine equipment.

Breezeway means a permanent Structure of a maximum of 4 m wide, forming part of a Principal Building by way of a shared foundation and roofline.

Brewery, Cidery, Distillery, Meadery or Winery means brewing or distilling of alcoholic beverages or alcoholic products with alcoholic content exceeding 1 % by volume that is licensed under the *Liquor Control and Licensing Act* to produce beer, cider, spirits, mead or wine.

Brewing & Vinting Outlet means to provide a facility where equipment for making wine and beer “on the premises” is available for customers to make their own wine or beer for personal use. A brewing and vinting outlet may not offer for sale, keep for sale, produce for sale, or sell wine or beer.

Building means anything constructed or placed on Land used or intended for supporting or sheltering any use, excluding Landscaping (Hard or Soft) and Docks.

Building Face means that portion of any exterior elevation of a Building exposed to public view from the vantage point of a Highway, extending from Grade to the soffit or the top of the Parapet Wall and the entire length of the Building elevation.

Building Frontage means the measurement of the length of a Building wall which directly faces a Highway.

Bulk Fuel Depot Means the use of premises to wholesale gasoline, fuel oil, heating oil, petroleum, **propane**, kerosene, coal, coke, fuel wood, **natural gas** or similar fuels.

Business means carrying on a Commercial or industrial undertaking of any kind or the providing of professional, personal or other services for the purpose of gain or profit, including Home Based Business, but does not include the activity carried on by the government, its agencies or government owned corporations.

Bylaw Administrator means:

1. the Town Manager;
2. the Corporate Officer;
3. the Development Services Manager;
4. the Operations Manager;
5. a Bylaw Enforcement Officer;
6. a Building Official; or
7. the designated of a person listed above.

Cabaret or Night Club means an establishment licensed to serve liquor in conjunction with live Entertainment and/or dancing as a liquor principle establishment under the Liquor Control and Licensing Act. In this definition, live Entertainment includes forms of adult Entertainment, including exotic dancing and stripping.

Campground means a site intended for the Temporary accommodation of travelers for vacation or recreational purposes in Recreational Vehicles, tent trailers or tents which are not occupied as principal residences or long term accommodations and excludes a Mobile Home Park or Recreational Vehicle Park, but may include Accessory Laundry, bathroom, shower facilities, Retail Store, Office, and Recreation Facilities, provided such uses are limited to the occupants of the Campground.

Camping Space means a designated area of a Campground intended for the siting of a Recreational Vehicle, tent trailer, or tent.

Cannabis means Cannabis as defined in the *Cannabis Act*.

Cannabis Retail means a use that is related to the promotion, advocacy, product or paraphernalia used in the consumption of cannabis and includes the retail sales of cannabis that may or may not be stored onsite and operates as an establishment licensed by the Province of BC.

Cannabis Processing Wholesale Sales means the Commercial production, processing, packaging and storage of cannabis and the wholesale sale of cannabis and cannabis products as authorized under the Cannabis Regulations under the Controlled Drugs and Substances Act (Canada), and does not include Cannabis Retail or the growing of cannabis by an individual for their personal use and consumption.

Cannabis Production & Wholesale Sales means the Commercial production, processing, packaging and storage of cannabis and the wholesale sale of cannabis, cannabis products, cannabis seeds and cannabis plants as authorized under the Cannabis Regulations under the *Controlled Drugs and Substances Act* (Canada), and does not include Cannabis Retail.

Canopy means a non-retractable hood cover or marquee which projects from the wall of a Building. It does not include an Awning, projecting roof, roof eaves, or enclosed Structure.

Cardlock Gas Station means the use of premises for the sale of motor fuels for Vehicles registered as commercial Vehicles, where motor fuel is dispensed by the customer who has been supplied with a card, key or other device for the operation of the fuel dispensing equipment.

Care Facility means a use licensed by the Province of BC under the Community Care and Assisted Living Act, to provide all or some combination of room, board, care, educational services, limited medical treatment, assistance with the performance of personal functions and activities necessary for daily living and supervision for more than 8 children or adults and may include limited overnight accommodation for shift workers. May include private living quarters with centralized dining services, shared living spaces, and access to social and recreational activities for residents. Typical uses include but are not limited to nursing homes with health care for dependent residents, rehabilitation, private mental hospitals, supportive recovery uses, private hospitals, personal care facilities and extended care facilities.

Carnival means a short-term use providing a variety of shows, games, and amusement rides in which the patrons take part.

Carport means a roofed Structure free standing or attached to the Principal Building which is not enclosed in the front and at least one side, used by the Building occupants to shelter parked Vehicles.

Casino means the use of premises for the purpose of playing or operating games of chance or mixed chance and skill on which money is wagered, and for which a license has been issued by the British Columbia Lottery Corporation, and may include player-operated video lottery terminals, slot machines, and non-player operated video lottery terminals, and accessory Entertainment uses excluding adult Entertainment.

Catering means the use of premises for the preparation of food for consumption off premises but does not include a retail store or restaurant selling food directly to the public.

Cemetery means Land, Buildings and/or Structures used as a place for interment for human remains or to memorialize the deceased.

Clearance means the unobstructed vertical distance between the Grade or finished floor and the underside of a Canopy, Awning, ceiling or Structure.

Commercial Composting Facility means a facility that processes organic matter to produce Compost at a scale larger than 500 m² and for Commercial purposes, in accordance with the Organic Matter Recycling Regulation and the Mushroom Compost Facilities Regulation.

Commercial Use means an occupation, employment or enterprise that is carried on for gain or monetary profit by any person.

Community Sewer System means a system of sewage disposal that conforms with the Environmental Management Act and Regulations (Municipal Sewage Regulation) or a Liquid Waste Management Plan that has been approved by the province.

Community Water System means a system of waterworks which is owned, operated and maintained by the District of Sicamous.

Compost means a product that is:

- a. A stabilized earthy matter having the properties and Structure of humus;
- b. Beneficial to plant growth when used as a soil amendment;
- c. Produced by composting; and
- d. Derived only from organic matter.

Contractor Services - General means development used for the provision of Building and road construction services including Land scaping, concrete, electrical, excavation, drilling, heating and plumbing or similar services of a construction nature which require on-site Storage & Warehouse space. Any sales, display, office or technical support service areas shall only be permitted as an Accessory Use.

Contractor Services - Minor means development used for the provision of electrical, plumbing, heating, painting and similar contractor services and the accessory sale of goods normally associated with the contractor services where all materials are kept within an enclosed Building, and there are no accessory manufacturing activities.

Council means the Municipal Council of the District of Sicamous.

Crematorium means a Building or Structure fitted with the proper equipment for the purposes of the cremation of human or animal remains.

CSA means Canadian Standards Association.

Dangerous Goods means a product, substance or organism included by its nature or by the regulations in any of the classes listed in the *Transportation of Dangerous Goods Act*.

Data Centre means a Building or portion thereof housing computer systems and associated components such as telecommunications, information storage, backup power generating equipment, environmental controls, fire suppression and security devices for the purpose of providing information technology services that are beyond the scale of information technology support for a single enterprise.

Day Care means a premise that is licensed and regulated by the *Community Care and Assisted Living Act: Child Care Licensing Regulation*, which provides care for 8 or more persons, for not more than 16 hours per day.

Deck means a Structure more than 0.6 m above Grade without a roof or walls, except for visual partitions and railings, used as an outdoor amenity area.

District means the District of Sicamous.

Drive-Through Service means the use of premises where customers order and receive services, food or other goods in their motor Vehicles via one or more designated drive-through lanes.

Dwelling Unit means a Building or a portion of a Building designed and used for human habitation for one Household, which contains sleeping facilities, one Kitchen and a bathroom.

Employee Dwelling Unit means a Dwelling Unit, intended for accommodation of persons such as an employee, manager, watchperson, or caretaker and may include a business owner where they live and work on the same Parcel.

Float Home means a Dwelling Unit on the water that is not a boat or watercraft, is permanently connected to land-based sewer, water and electrical services, with dues paid to maintain the dock, slip and services, and built and moved into place on a long term or permanent basis.

Multi-Unit Dwelling means any Building consisting of three or more Dwelling Units, each of which is occupied or intended to be occupied as the permanent residence of one household.

Single-Unit Dwelling means a Dwelling containing one Dwelling Unit, including a Modular Home, but not including a Mobile Home.

Two-Unit Dwelling means a Dwelling containing two Dwelling Units, including a Modular Home, but not including a Mobile Home.

Eating Establishment means a commercial establishment which serves prepared food or beverages to persons seated within a Building and associated outdoor spaces for consumption on or off the premises and includes restaurants, coffee shops, bakeries, tea rooms, pubs, outdoor cafes, catering establishments, and premises licensed as “food principal” under the *Liquor Control and Licensing Act*.

Educational Facility means premises used for education or training purposes, and may include various types of classrooms, administration offices, storage and maintenance areas and dormitories to house students. Typical uses include but are not limited to public or private elementary, middle and secondary schools, community colleges, universities, and business, special educational program, technical, trade and vocational schools.

Electric Vehicle Charge Station means a public or private parking space that is served by battery charging station equipment that has as its principal purpose the transfer of electric energy (by conductive or inductive means) to a battery or other energy storage device in an electric Vehicle.

Employee Accommodation means Sleeping Units where employees are provided with common living, meal preparation, and laundry facilities.

Entertainment, Recreation & Sports Centre means a facility providing for a wide range of assembly functions such as conventions, Entertainment and sporting events, civic recreational services and programs, Fitness Centres, kinesiology and sports medicine clinics, and includes limited Office uses, Retail Store, Eating Establishments, dormitories and other services accessory to the Principal Use.

Entertainment Use means facilities which provide for the enjoyment of patrons, and includes but is not limited to Theatres, dancing establishments excluding adult entertainment businesses, various performance facilities, and production or rehearsal studios.

Escort Service means a business providing social companionship by employees of the business or by other persons to whom customers of the business are referred.

Exhibition & Convention Facilities means a Building or site used to provide permanent facilities for meetings, seminars, conventions, product and trade fairs and similar exhibitions.

Family Day Care means a Home Based Business where care facilities for a maximum of 7 persons in care in accordance with the *Community Care and Assisted Living Act* and associated regulations.

Farm Use means an occupation or use of a Parcel for farm purposes, including farming of Land , plants and animals and any other similar activity designated as Farm Use by and in accordance with the *Agricultural Land Commission Act* and related Acts and Regulations, and includes but is not limited to activities such as farm retail sales; storing, packing, preparing and processing farm products; a Brewery, Cidery, Distillery, Meadery or Winery; and Agri-tourism Activities and includes farm operation.

Farm Product means a commodity that is produced from a Farm Use as defined in the *Agricultural Land Commission Act* or designated by regulation.

Farm Product Processing means the process of adding value to a Principal farm commodity or product by physical, biological or other means including, but not limited to, fermentation, cooking, canning, smoking or drying.

Farm Retail Sales means the sale of Farm Products.

Fence means a vertical Structure use to form a boundary to enclose or screen a Parcel or an area but does not include a Retaining Wall.

Financial Services means the provision of financial and investment services by a bank, trust company, investment dealer, credit union, mortgage broker, or similar business.

Firearm means a rifle, pistol or other barreled weapon from which a projectile can be discharged.

Fitness Centre means the use of premises for the development, on an individual or group session basis, of physical fitness including health centres, gymnasia, racket and ball courts, reducing salons, yoga, pilates, weight loss, dance, self-defence, sports and similar uses.

Fleet Service means a collection of Vehicles for the delivery of people, goods or services, where such Vehicles are not available for sale or long-term lease. Typical uses include but are not limited to ambulance services, water taxi services, float plane terminal, bus terminal, Outdoor Storage of a fleet of rental Vehicles, messenger and courier services.

Floor Area means the total of the horizontal areas of every room and passageway contained in a Building but not including the horizontal area of basements, attached Garages, the Garage area of a Carriage House, sheds, open porches, or Breezeways.

Total Floor Area means the sum of the Floor Area of a Building or Buildings, excluding floor space under a ceiling which is less than 1.8 m above Grade.

Foreshore means the area of Land between the Natural Boundary and low water levels of Shuswap Lake, Mara Lake or the Eagle River.

Forestry means extraction, storage, sorting and grading of Principal forest materials. This use does not include Natural Resource Processing.

Funeral Service means premises used for the care and preparation of human remains for interment or cremation and may also include holding of bereavement rites and ceremonies and associated retail sales of funeral products, such as caskets, urns and other products, as Accessory Uses.

Garage means an Accessory Building or part of a Principal Building designed and used for the shelter or storage of Vehicles and includes a Carport.

Golf Facility means an area operated for the purpose of playing golf or practicing golf from individual tees, and may include one or more of the office, Retail Store, Eating facilities, lounge, golf driving

following as an accessory use:
Establishment, banquet range, and golf academy.

CONTINUED

Grade means the elevation calculated by averaging the elevation of Natural Grade or finished grade, whichever is lower, at any points at which any part of a Building comes into contact with the surface of a Parcel, excluding any artificial mounds of earth or rocks placed at or near the wall of a Building, and excluding the minimum window well width and depth required by the *British Columbia Building Code*.”

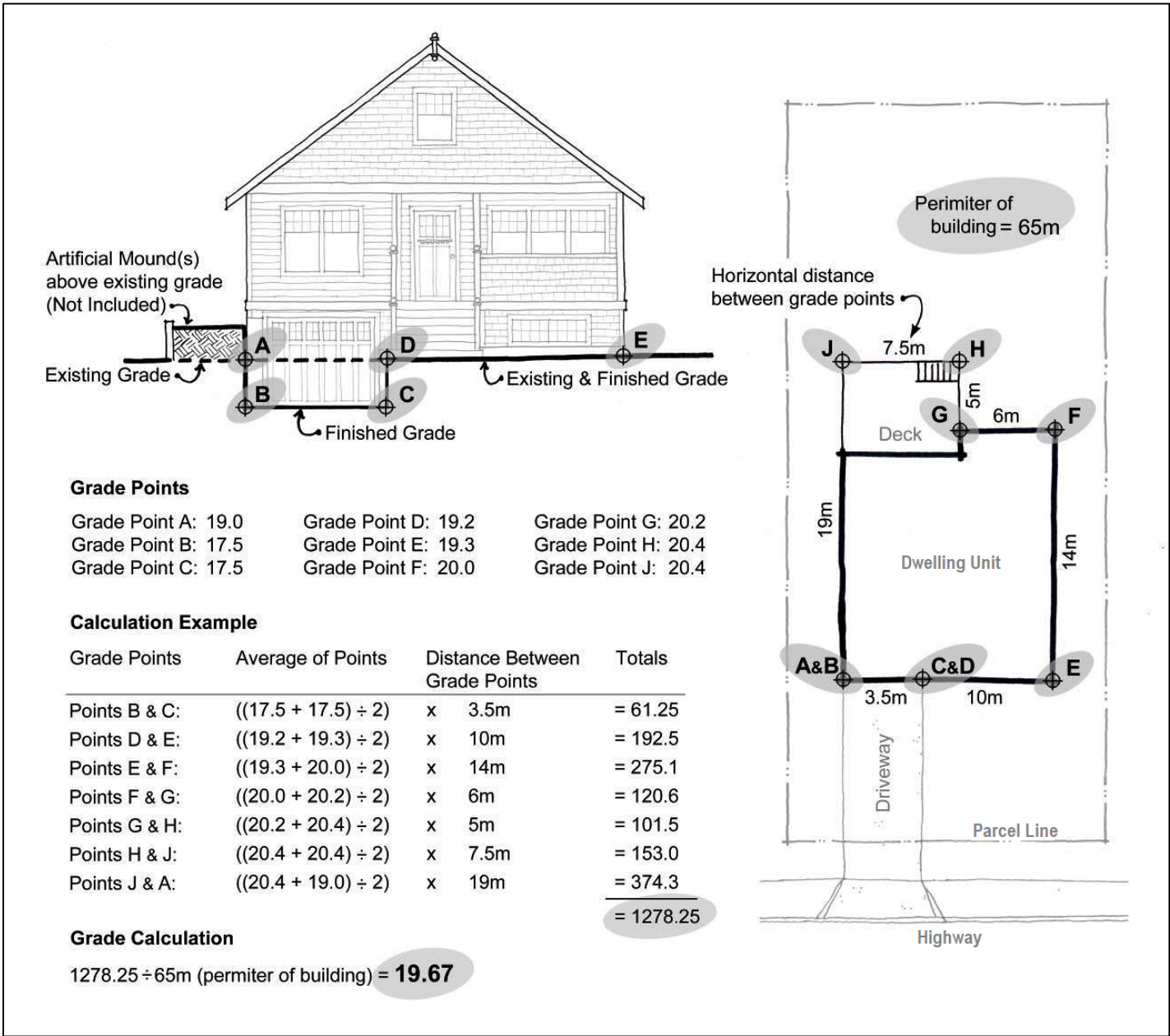

Natural Grade means the average elevation of the surface of the ground prior to grading, filling, or other site alterations, calculated from the four corners of the smallest rectangle that encompasses the Structure or the roof area of a Building, whichever is greater.

Greenhouse or Plant Nursery means premises used for the cultivation, storage or sale of plants, trees, bushes, sod and related gardening products and materials.

Ground-Oriented means having an exclusive and direct access to a private open space area, other than a balcony or sun Deck.

Health Clinic means a premise used for the provision of physical or mental health services on an out-patient basis. Services may be of a preventative, diagnostic, treatment, therapeutic, rehabilitative, or counselling nature. Typical uses include but are not limited to medical and dental offices, chiropractors, massage therapists, acupuncture clinics and counselling services.

Height means, when used in reference to a Building, the greatest vertical distance between the lower of Average Natural Grade and average finished Grade and the highest point.

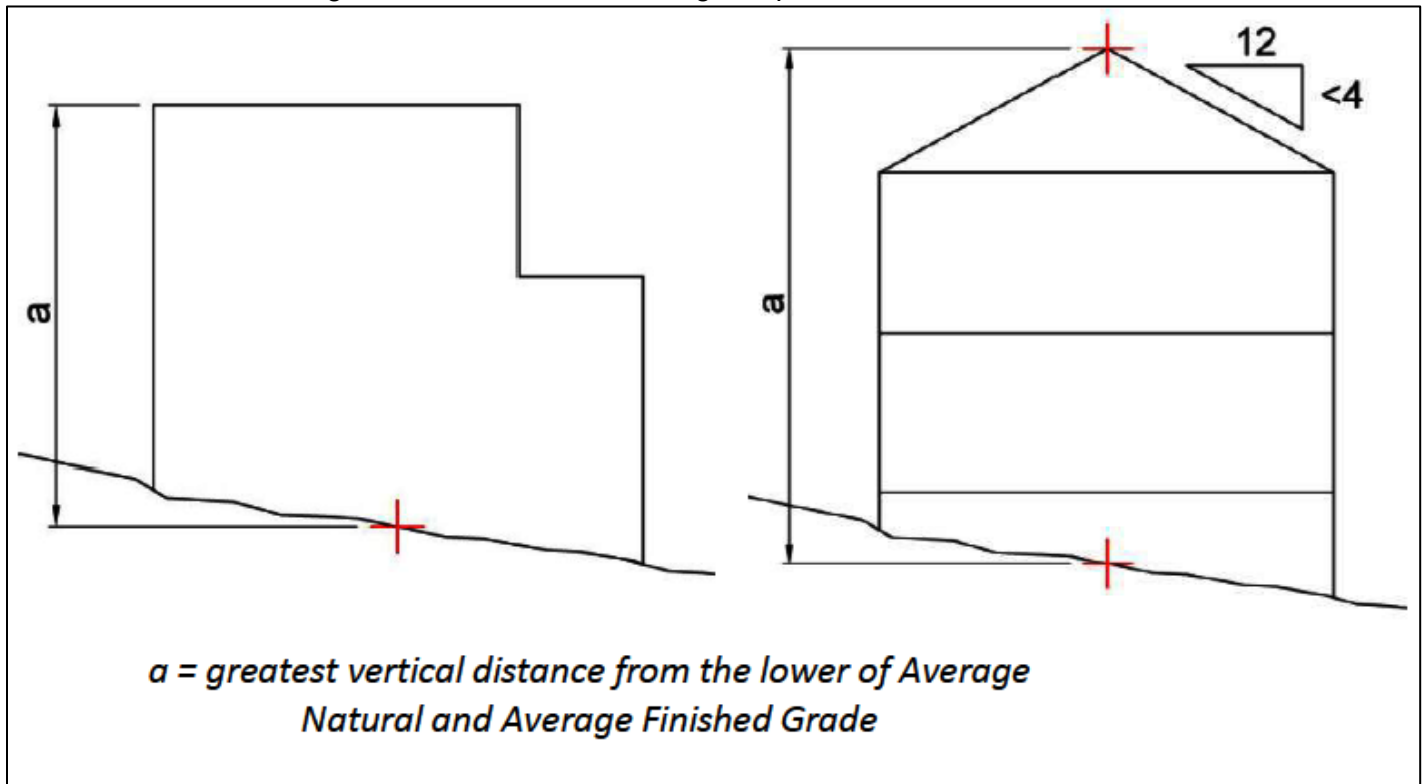

Heavy Equipment Sales, Service and Repair means the sale, rental, service, or repair of heavy Vehicles, machinery or mechanical equipment typically used in Building, roadway, pipeline, oil field and mining construction, manufacturing, assembling and processing operations and agricultural production. This does not include automobiles and recreation Vehicle sales/rentals.

Heliport means any area designed, prepared, equipped, or set aside for the arrival, departure, movement, storage or servicing of helicopters, and includes any associated Buildings, installations, open space, and equipment in connection therewith. It may include Temporary Residential Uses for emergency personnel.

Highway means a public street, road, path, lane, walkway, trail, bridge, viaduct, thoroughfare and any other way, but specifically excludes private access on private property.

Hobby Beekeeper the keeping of four or less honeybee hives.

Home Based Business means an occupation or profession by a resident of the Dwelling Unit that is Accessory to the Residential or Agricultural use of the Parcel that does not change the Residential or Agricultural character or appearance of the Dwelling Unit, Building or Parcel. A Home Based Business may include Family Day Care.

Houseboat means a motorized watercraft designed and intended for navigation with a height above the waterline greater than 3 m and a length greater than 7.6 m and may contain facilities for Temporary habitation including bathroom and kitchen facilities.

Houseboat Buildings & Structures means Buildings or Structures used to house or repair houseboats.

Houseboat Operation means a Commercial facility that provides for the rental of Houseboats and may also include, as accessory uses, administrative Offices, Eating Establishments, Retail Stores, Laundry, shower facilities, related Fleet Services, together with incidental maintenance, repair, outdoor storage, Marine Fueling Station, and washing of Houseboats.

Household means:

- a. A person occupying a Dwelling Unit alone; or
- b. Two or more persons related by blood, marriage, common-law, adoption or foster parenthood sharing one Dwelling Unit; or
- c. Not more than five unrelated persons including boarders, who are not related by blood, marriage, or adoption, sharing a Dwelling Unit; or
- d. Unrelated persons sharing a Dwelling Unit with related persons provided that the number of unrelated persons does not exceed the number of bedrooms within the Dwelling Unit.

Impermeable Surface means a material which does not allow water or other liquid to readily penetrate or pass through.

Indoor Recreation means a Building or Structure which contains sports or recreation facilities, including but not limited to indoor swimming pools, ice arenas, curling rinks, courts for racquet sports, exercise centres, martial arts studios, gymnastics facilities, climbing walls, roller rinks, bowling alleys, miniature golf, batting cages, billiard halls and minor retail sales, Eating Establishment, and similar services customarily associated with and accessory to such facilities.

Institutional Use means the use of Lands, Buildings or Structures for: government services, police, ambulance and fire stations, courts of law, legislative chambers and offices, archives and meeting rooms accessory thereto whether on the same property or not; public detention centres, public schools, social services, public healthcare facilities, Religious Institution, community care facilities, child daycare facilities, utilities and Parks.

Kenel means any Building, Structure, compound, group of pens or cages that lodges dogs, cats or similar animals used as household pets for another person for financial gain and may include accessory office, retail sales of related products, breeding, grooming, training, and boarding facilities.

Kitchen means facilities for the preparation or cooking of food, and includes any room containing counters, cabinets, plumbing or wiring used for the preparation or cooking of food but does not include a wet bar.

Land includes the surface of water.

Landscape Buffer Area means an area free of all Buildings and Structures consisting of Soft Landscaping, the purpose of which is to separate different Land uses and may include Hard Landscaping.

Hard Landscaping means any combination of boulders, paving, planters, sculptures and fences, arranged and maintained so as to enhance and embellish the appearance of a property, or where necessary, to effectively screen a lot, site or storage yard, but does not include Off-Street Parking areas.

Soft Landscaping means any combination of trees, shrubs, annuals, and perennials (ornamental or native); turf; bark mulch and gravel; arranged and maintained so as to enhance and embellish the appearance of a property, or where necessary, to effectively screen a Parcel, site or storage yard, but does not include Off-Street Parking areas and does not constitute riparian area restoration or enhancement within a SPEA, though could be included as a measure to protect a SPEA.

Lane means a Highway more than 3 m but not greater than 8 m in width, intended to provide secondary access to Parcels of Land. A Lane is not to be considered a partial Highway.

Laundry means a Building used for the purpose of receiving articles or goods of fabric or leather to be subjected to the process of dry cleaning, dry dyeing, or cleaning, processing or repairing elsewhere and for the distribution of any such articles or goods which have been subjected to any such processes. Also means a Building or portion thereof where machines for the washing and drying of articles or goods of fabric are provided to be operated by customers.

Light Industry means a use providing for the manufacturing, processing, storing, transporting, distributing, wholesaling, servicing or repairing of goods, materials or things such as (but not limited to) industrial bakeries, custom manufacturing, boat construction, prefabricated home manufacturing, creative product manufacturing, and artisan industrial uses.

Light Vehicle Sales & Rental means the retail sale or rental of new or used automobiles, boats, motorcycles, snowmobiles and light trucks and similar Vehicles and small equipment, together with incidental maintenance services, storage, fueling, washing, and sales of parts. It includes automobile dealerships, including automobile wholesale brokers, but does not include dealerships for the sale or rental of Vehicles with a gross Vehicle weight of more than 4100 kg or the sale of motorhomes with a gross Vehicle weight rating of more than 5500 kg or a length of more than 6.7 m.

Livestock Processing or Abattoir means a facility where animals are slaughtered and processed.

Loading Space means an area of a parcel reserved for Temporary parking for the purpose of loading or unloading passengers, goods or materials.

Manufacturing means the making of goods by hand or by machine that upon completion the manufacturer sells to a customer.

Marine Fueling Station means the use of a premises for the sale of fuels for boats and marine vessels, combined or separate from a Marina.

Media Production Studio means a facility that is equipped for sound recording, the transmission of radio and television programs, or the production of motion pictures, television programs, videos, music, sound recording, cellular phone applications or video games.

Mobile Home means a dwelling unit that is manufactured and assembled in a factory to Canadian Standards Association Z-240 MH Standard and which is intended to be capable of movement from place to place and intended to be occupied other than in its place of manufacture.

Mobile Home Park means any parcel on which are located 2 or more Mobile Homes.

Mobile Home Space means a designated area or a subdivided area under the Strata Act of a Mobile Home Park for the siting of Mobile Homes but does not include roadways, common amenity and accessory area uses.

Mobile Vending Unit means a vendor who sells food and retail products from mobile equipment which is capable of being moved on its own wheels without alteration or preparation and is fully self-contained with no service connection required.

Modular Home means a Single-Unit Dwelling or Two-Unit Dwelling constructed to the CAN/CSA A277 standard, built in 2 or more sections to be assembled on a permanent foundation.

Moorage means a place where a boat or marine vessel is anchored or attached to a permanent Structure.

Dock means a Structure made up of fixed or floating sections used for the purpose of mooring boat(s) which may include multiple Berths.

Fixed or Removable Walkway means a Structure used for providing pedestrian access to and from a Dock with a physical link to shore.

Group Moorage Facility means 1 or more multi-berth fixed or removable docks for the providing of commercial moorage, or communal moorage to an adjacent multi-unit Residential development or a group or association of residents.

Marina means a facility that which provides moorage space for watercraft and may also include, as accessory uses, administrative Offices, recreational lounges, Eating Establishments, the Retail Sales of marine supplies and equipment, laundry, shower facilities, Recreation Equipment Rental, Boat Repair, Boat Storage, Marine Fueling Station, water taxi and emergency services docks.

Private Moorage Buoy means a small floating Structure used for the purpose of boat moorage, typically composed of rigid plastic foam or rigid molded plastic, and specifically manufactured for the intended use of boat moorage.

Municipal Solid Waste Facility means a facility designed, constructed and operated for the collection, processing, transferring or disposal of the solid waste stream or components thereof, including but not limited to, transfer stations, material recycling facilities, composting facilities and disposal facilities.

Natural Boundary means the visible high water mark of a Watercourse where the presence and action of the water are so common and usual, and so long continued in all ordinary years, as to mark on the soil of the bed of the watercourse a character distinct from that of its banks, in vegetation, as well as in the nature of the soil itself.

Natural Resource Processing means a use providing for the conservation, management, and extraction of principal forest, mineral, and other resource materials. Specifically, this includes the preliminary grading, cutting, or crushing of such material for shipment but excludes manufacturing or processing not mentioned above. A resource use may occupy a Building of up to 56 m². This use excludes batching plant.

Nature Centre means the use of Land, Buildings or Structures for the use of educational programs and tours, special events and exhibits, galleries and theatres, and Accessory Offices, operated Accessory to a Nature Sanctuary.

Nature Park means use of Land, Buildings or Structures primarily for conservation and enjoyment of natural areas. Uses can include Boardwalks, trails, environmentally sensitive areas, minor gathering areas and Nature Sanctuaries.

Nature Sanctuary means the non-Commercial Use of Land, Buildings or Structures for the preservation of plant and animal life and may also include a Nature Centre.

Neighbourhood Energy Utility means a mechanical system that delivers or exchanges heat or hot water or electrical energy between lots of Land within a proximate area.

Neighbourhood Recycling Collection Area means the Accessory Use of a portion of a Parcel where permitted, for the Temporary siting of a roll-off container designed for the purpose of collecting and transferring household recyclable materials to a Recycling Depot.

Off-Street Parking means the accessory use of a Parcel for parking spaces and maneuvering aisles required by other use(s), Building(s) or Structure(s) on that Parcel (or off that parcel) in accordance with Schedule D.

Office means a Building primarily used for conducting the affairs of business, including the provision of administrative, business, clerical and secretarial agencies, consulting, financial, government services, health services, high technology services, insurance, legal, management, professional, and real estate services.

Outdoor Market means a Temporary Use where groups of individual sellers offer new and used goods, crafts or produce for sale directly to the public. This may consist of vendors that include liquor sales and tasting within an outdoor market in accordance with the requirements of the BC Liquor and Cannabis Regulation Branch.

Outdoor Recreation means public and private unsheltered activities for civic, social, educational, Entertainment or like purposes.

Outdoor Storage means the storage of equipment, goods, or materials in the open air where such storage of goods and materials does not involve the erection of permanent Structures or the material alteration of the Land. Typical uses include but are not limited to storage of construction material, Vehicles and heavy equipment.

Owner means the registered owner of an estate in fee simple or their agent authorized in writing and includes the tenant for life under a registered life estate, the registered holder of the last registered agreement for sale.

Parcel means a single area of Land, designated and registered at the Land Title Office as not more than one Parcel of Land, and if a Parcel of Land is divided by a lane or otherwise, each division thereof constituting a single area of Land shall be deemed to be a separate parcel, and includes a Strata Parcel in a bare Land strata plan but does not include any other Strata Parcel or an air space parcel.

Abutting Parcel means immediately contiguous to, or physically touching, and when used with respect to lots, means 2 Parcels that share a common Parcel Line.

Corner Parcel means a Parcel having a continuous Highway frontage on two or more Highways.

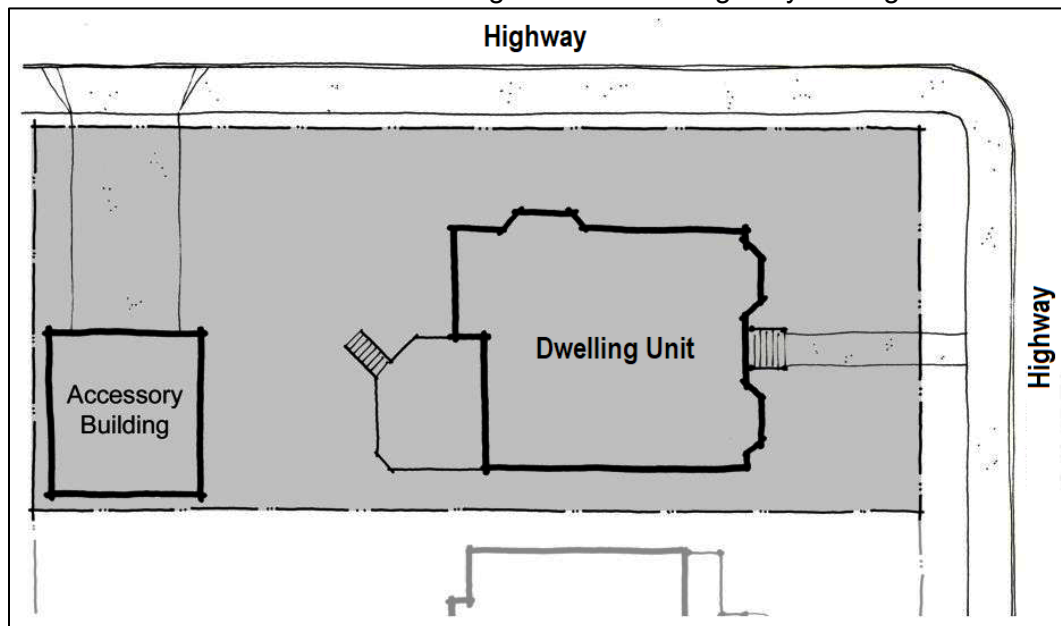

Panhandle Parcel means a Parcel that has less than 10% of its perimeter adjoining a Highway and/or in part consists of a Panhandle driveway.



Parcel Area means the extent of a Parcel taken in a horizontal plane but does not include any portion of the Parcel below the Natural Boundary.

Parcel Coverage means the portion of a Parcel taken up by Buildings and Structures.

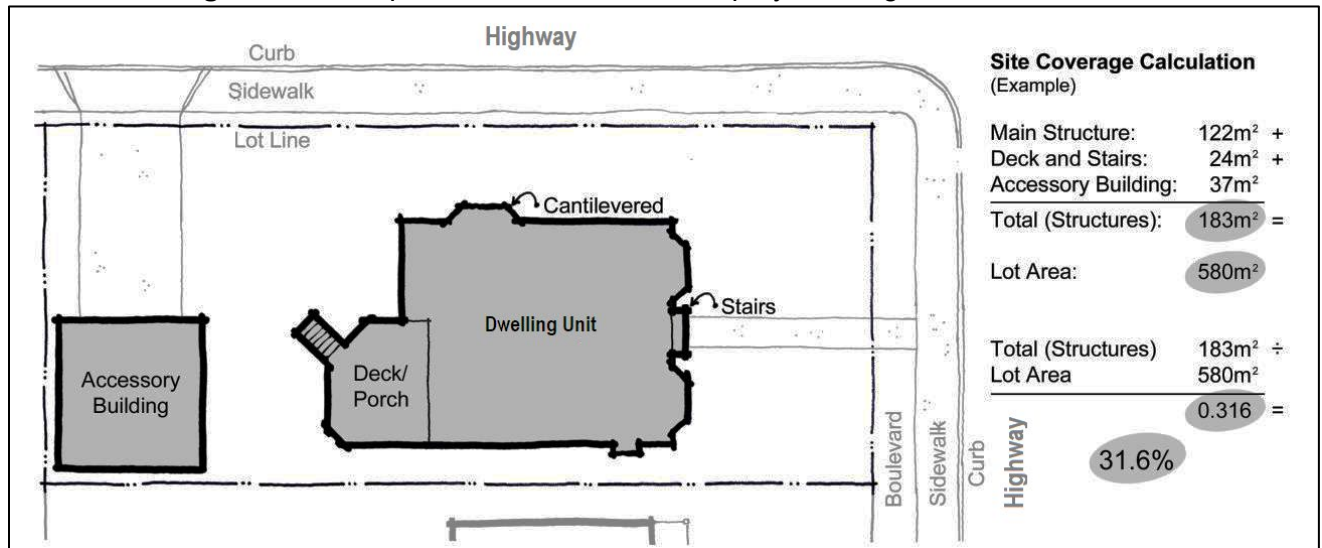

Parcel Depth means the average distance between the Rear Parcel Line or a point opposite of, the Front Parcel Line of a Parcel.

Parent Parcel means the original Parcel of Land that was or is proposed to be the subject of a plan of subdivision.

Strata Parcel means a Parcel shown on a strata plan according to the *Strata Property Act*.

Through Parcel means a parcel Abutting 2 parallel or approximately parallel Highways, other than Lanes.

Parcel Width means the length of the Front Parcel Line except in the case of an irregularly shaped lot, where the width shall be the horizontal distance between the Side Parcel Lines at the Front Parcel Line setback. For a reverse pie-shaped lot, the Parcel width is the horizontal distance between the Side Parcel Lines at the Rear Parcel Line Setback.

Parcel Line means a legal boundary of a Parcel.

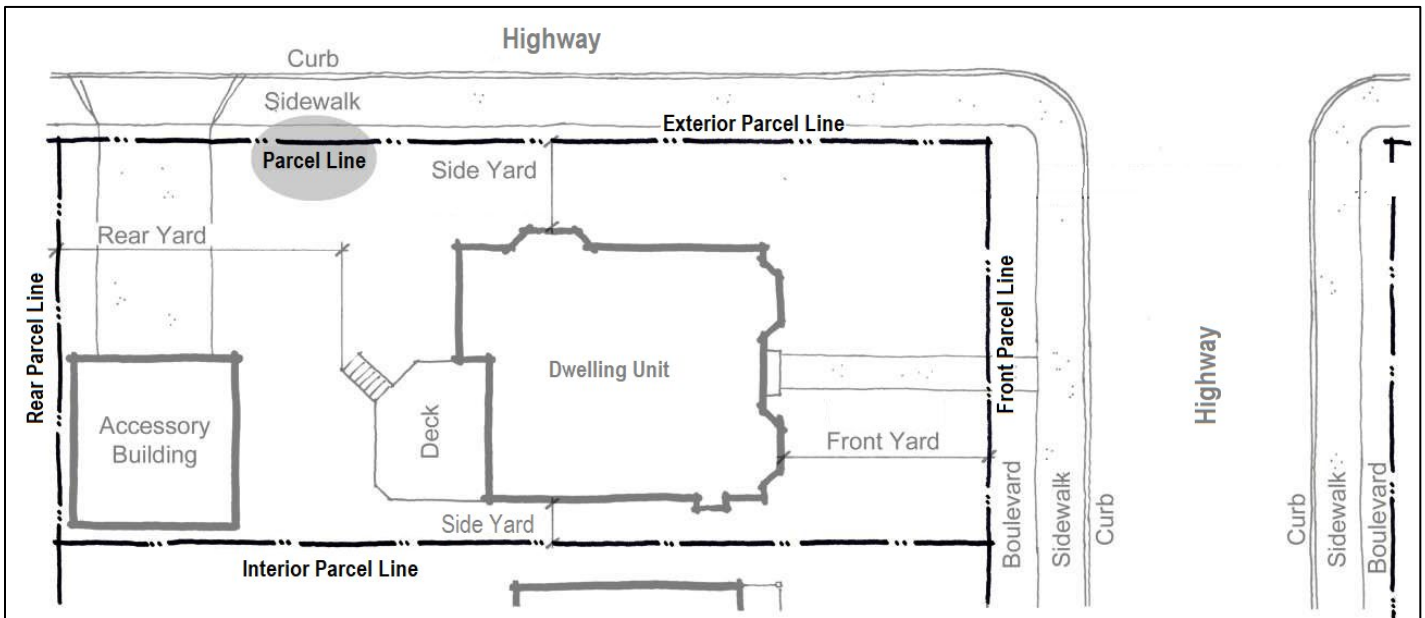

Exterior Side Parcel Line means a Parcel boundary, other than a Front Parcel Line or a Rear Parcel Line, which abuts a Highway.

Front Parcel Line means a Parcel boundary common to a Parcel and a Highway other than a Lane, and where a Parcel is contiguous with the intersection of two Highways, the Front Parcel Line is the shortest Parcel boundary adjoining a Highway other than a Lane, except:

- a. where a Parcel is a Through Parcel where there is no shortest Parcel Line, the Front Parcel Line is the Parcel Boundary to which the Building Face or the Principal Building parallels;
- b. where the Parcel is a Panhandle Parcel, the Front Parcel Line is the line separating the body of the Parcel from the panhandle.

Interior Side Parcel Line means a Parcel boundary between two Parcels, other than a Front Parcel Line, Exterior Side Parcel Line or a Rear Parcel Line, which does not run along a Highway.

Rear Parcel Line means a Parcel boundary that lies most opposite to and is not connected to the Front Parcel Line.

Parapet or Parapet Wall means that portion of a perimeter Building wall that rises above the roof.

Park means Land which is owned by the District or other government which Land is dedicated for public use for recreational and or conservation purposes.

Parking Lot or Parkade means a Parcel or part of a Parcel or a Building available to be used for the Temporary Commercial parking of more than 1 Vehicle.

Park Model Trailer means a Recreational Vehicle recreational unit that conforms to CAN/CSA Z-241 series of standards for park model trailers at the time of manufacture, with a width greater than 2.6 m in transit mode and a maximum interior area of 50 m² when in the setup mode.

Party Wall means a wall jointly owned and jointly used by two parties under easement agreement or by right in law, and erected at or upon a line separating two Parcels of Land, each of which is, or is capable of being, a separate real estate entity.

Patio means any solid Structure at finished Grade meant for support of people or materials outdoors and less than 0.6 m in Height.

Pawn Shop means an establishment that engages, in whole or part, in the business of loaning money on the security of pledges of personal property, or deposits or conditional sales of personal property, or the purchase or sale of personal property.

Personal Service Establishment means the use of premises to improve beauty and wellness through styling, cutting, or chemical treatment of hair and through skin and body treatments, including pedicures, manicures, facials, microdermabrasion, electrolysis, waxing, laser, hydrotherapy, anti-aging, skin rejuvenation therapy, aromatherapy, stone therapy massage, sauna, relaxation massage and related services.

Pet Day Care – Indoor means a facility which offers care for pets indoors, but specifically excludes overnight boarding.

Pet Day Care – Outdoor means a facility which offers care for pets inside or outdoors, but specifically excludes overnight boarding.

Prefabricated Home Sales means a Building or Parcel used for the display and sale of Modular and Mobile Homes, as well as Park Model Trailers.

Principal Building means any Building used to accommodate a Principal Use.

Principal Use means the main or primary use of Land, Buildings and Structures, specifically permitted in the zones established by this bylaw.

Public Utility means a use providing for the essential servicing with water, sewer, telephone, electrical, television, refuse disposal and similar services where such services are provided by a government organization, Crown Corporation, Improvement District, or by a company operating under the *Water Utilities Act*.

Recreation Equipment Rental means the rental of new or used boats, marine craft and similar light recreational equipment such as bicycles, canoes, and kayaks, with minimal on-site facilities for maintenance or Seasonal storage. This use does not include Recreational Vehicles.

Recreation Equipment Sale, Service & Rentals means Recreation Equipment Rental as well as the rental of new or used travel trailers or similar light recreational equipment, together with maintenance services, storage, and sales of parts. It does not include dealerships for the sale of Recreational Vehicles with a gross Vehicle weight rating of more than 5500 kg or a length of more than 6.7 m.

Recreation Facility means the provision of social or recreational activities or facilities for the purpose of gain or profit, and includes social recreation uses such as, but not limited to, Indoor Recreation, Social Clubs, and Entertainment Use. This use does not include Cabaret or Night Club.

Recreational Vehicle means any camper, travel trailer, fifth wheel trailer or motor home with a maximum width of 2.6 m in transit mode which can be used to provide sleeping accommodation and which is capable of being licensed for highway use pursuant to the *Motor Vehicle Act*.

Recreational Vehicle Park means a site intended for the accommodation of persons in recreational Vehicles or park model trailers, and excludes a mobile home park or campground, but may include an accessory laundry, bathroom, shower facilities, retail store, office, and recreational facilities, provided such uses are limited to the occupants of the Recreational Vehicle Park.

Recreational Vehicle Sales, Service & Rental means the rental of Recreational Vehicles, travel trailers, campers, and tent trailers together with maintenance services, storage, and sales of parts.

Recreational Vehicle Sanitary Dump Station means a system of piping designed to accept waste from sanitary sewage holding tanks or Vehicles other than septic tank trucks.

Recreational Vehicle Space means a designated area, or Parcel subdivided under the *Strata Act*, of a Recreational Vehicle Park intended for the siting of a Recreational Vehicle or Park Model Trailer, but does not include common amenities, Usable Open Space, and Accessory Use areas.

Recreational Vehicle Strata Park means a site intended to be subdivided under the Strata Act for the individual ownership of recreational Vehicle spaces.

Recreational Water Activities means leisure activities that take place in areas associated with the water and water access, such as swimming, boating, fishing, water skiing and diving.

Recycling Depot means a Building or Parcel used for the collection, purchase and sale, sorting, processing and Temporary storage of recyclable materials including, but not limited to cardboard, plastics, paper, metal, bottles and similar household goods or items returnable for deposit.

Recycling Plant means the use of Land, Building, or Structures for the purposes of consolidating materials for transportation or the processing recyclable materials into other usable materials or products.

Religious Institution means one or more Buildings wherein persons assemble for religious worship or related educational, social, recreational or charitable activities. These institutions may include a columbarium Structure with associated services as an Accessory Use.

Repair Shop means a shop at which household items or other small motors or electrical devices may be repaired, but specifically excludes Vehicle Service & Repair.

Residential Use means a use providing for the permanent accommodation and home life of a Household.

Retail Store means an establishment where goods, merchandise, other materials are offered to the general public and includes limited on-site and outdoor storage or limited Seasonal outdoor storage. Typical uses include but are not limited to grocery, hardware, pharmaceutical, tourist goods stores, appliance, sporting goods stores, and printing services. This use excludes Cannabis Retail.

Retaining Wall means any Structure other than a Building wall which is constructed to hold back, stabilize, or support an earthen bank.

Streamside Protection and Enhancement Area (SPEA) means an area beside a Watercourse that is defined by *Riparian Areas Protection Regulation* as a “stream”.

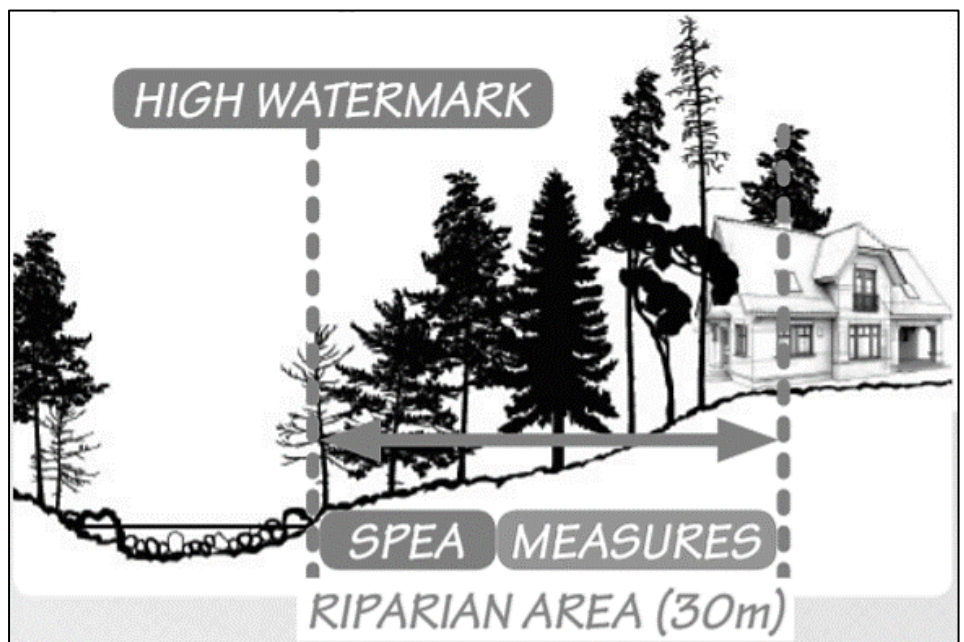

Scrap & Recycling Yard means a use where Vehicles and associated parts, scrap metal, used Building materials, discarded or salvaged materials are collected, stored, disassembled, repaired, re-sold, shredded or crushed for recycling.

Screening means a continuous Fence, wall, compact hedge or combination, supplemented with Soft Land scaping that effectively provides a visual separation or enclosure for the site, and is broken only by limited access points for pedestrians and Vehicles.

Seasonal means a use or activity in a facility or area for less than 12 months of the year.

Secondary Dwelling Unit means a Secondary Suite, Coach House or Garden Suite that contains a Dwelling Unit subordinate in size to the Principle Building on the same Parcel.

Coach House means a Dwelling Unit that is contained within an Accessory Building.

Garden Suite means an Accessory Building used for the purpose of accommodating an accessory Dwelling Unit and shall not include a Mobile Home, Park Model Trailer, or Recreational Vehicle.

Secondary Suite means an accessory Dwelling Unit contained within a Single-Unit Dwelling or attached via a Breezeway.

Service Industry means the use of Land or Buildings for wholesale sales or the testing, assembling, cleaning, distribution, servicing, printing, repair and maintenance of goods and materials, and the sale or rental of tools, lawnmowers, garden equipment and other similar goods.

Service Establishment means businesses engaged in activities associated with the Service Industry.

Service & Repair Establishment means a business at which a range of low impact and small-scale services are offered including repair of household items or other small motors or electrical devices, but specifically excludes automobile repairs or painting.

Setback means the required distance from a Parcel Line to any area of a Parcel on which a Building or Structure may be sited under Part 4 of this Bylaw.

Shipping Container means a prefabricated metal container or box specifically constructed for the transportation of goods by rail, ship or transport truck.

Shopping Centre means one or more Buildings designed as an integrated unit to be used for Retail Stores, Offices, Eating Establishments, arcades, internet centres, cinemas, exercise studios, Personal Service Establishments, Repair Shops, Vehicle Service & Repair, and garden centres. A Shopping Centre may be used on a temporary basis for Carnivals.

Short Term Rental means the use of a Dwelling Unit as a Sleeping Unit.

Sign means any identification, description, illustration, Structure or device visible from a public place which is intended to direct attention to a product, service, place, activity, person, institution, business or solicitation and specifically, may be part of a wall, Vehicle, or free standing device;

Interpretive Sign means indoor or outdoor panels that include geographical or cultural information relevant to a place, that are in accordance with the Sign bylaw, and may include interactive kiosks; messages imbedded in the ground, such as in concrete; small signs affixed to Buildings; projected lettering or images; or other similar objects.

Sign Shop means the use of Land, Buildings, or Structures for the purpose of manufacturing, installing, repairing, designing, and selling Signs.

Sleeping Unit means a unit of accommodation, not subject to a tenancy agreement, for rental on a daily, weekly, or monthly rate and may include a bathroom and cooking facilities.

Social Club means the use of premises by a non-profit society, association or corporation organized solely for the promotion of some common purpose and which is operated for fraternal, social or recreational purposes only, but does not include Religious Institution, hospital, social service centre, Care Facility and group residence or premises used for Residential or administrative purposes.

Storage & Warehouse means the storage of goods, wares, merchandise, substances, articles, or things, whether or not the storage is contained in separately occupied, secured storage areas or lockers and includes Truck Terminal.

Storage Facility means a self-contained Building or group of Buildings containing lockers available for rent for the storage of personal goods or a Warehouse used exclusively to store bulk goods of a non-hazardous nature.

Storey means that portion of a Building which is situated between the top of any floor and the top of the floor or ceiling above it.

Storey Area when used in reference to a floor of a Storey of a Building, “area” means the entire horizontal plane, which in plan, is enclosed by the interior face of the exterior walls of the Storey at floor level plus the area enclosed by any cantilevered element that is within that Storey and that is above floor level, but does not include of the following areas:

- The area used or intended to be used for required parking or movement of Vehicles, as set out in this bylaw, which is calculated starting from the lowest level of the Building;
- The area used or intended to be used for required bicycle parking, long-term, as set out in this bylaw, which is calculated starting from the lowest level of the Building;
- The area or areas of Balconies, exposed Decks, Patios or roofs; and
- The area of elevator shafts.

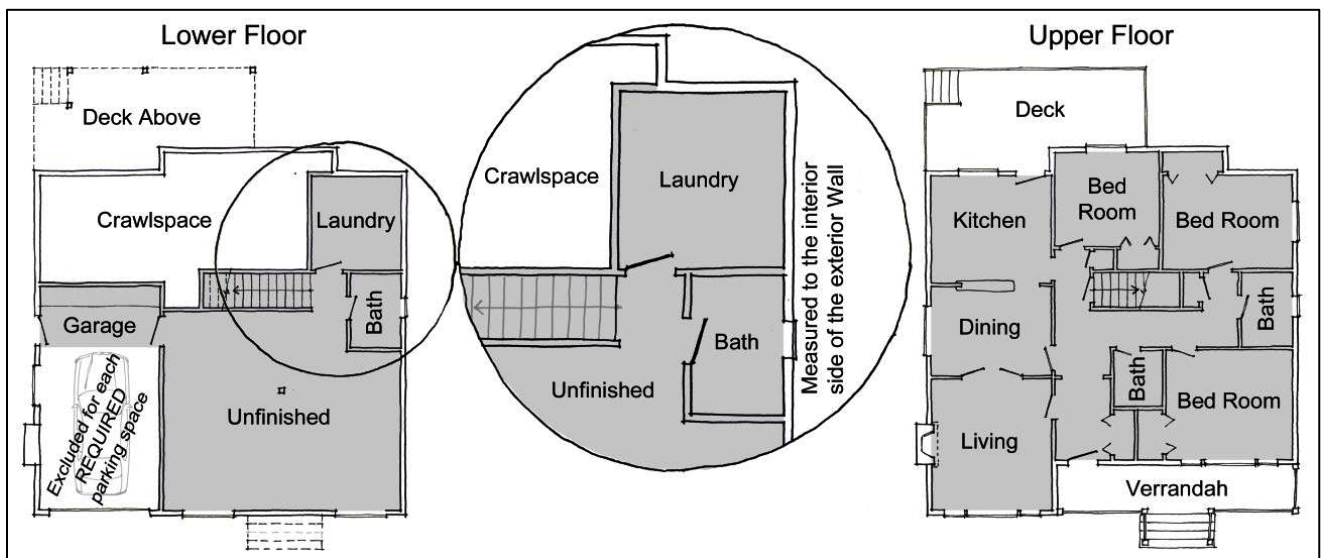

First Storey means the lowest storey having its floor level not less than 2.0 m averaged Grade.

Structure means any construction fixed to, supported by, or sunk into Land or water and excludes a Trellis or Hard Land scaping less than 2 m in height, and a Fence.

Swimming Platform means a floating, roofless, Structure with at least one ladder used for non-motorized Recreational Water Activities, but not boat mooring.

Take-Out Restaurant means an Eating Establishment which provides no more than 6 seats for customers to consume food on the premises, and which does not serve food via drive-through service. This definition includes Eating Establishments and Mobile Vendors which have no provision for consumption of food on the premises.

Tandem Parking means two parking spaces, one behind the other, with a common or shared point of access to a maneuvering aisle, Lane or Highway.

Temporary Use means a use operating on a Residential Parcel not exceeding 180 days, and not exceeding a single Season on a property zoned for Commercial, Industrial or Agricultural uses.

Theatre means a Building used or intended to be used for live dramatic performances or for the projection of motion picture films, but specifically excludes drive-in theatres.

Tourist Accommodation means Land, Buildings or Structures which provides temporary accommodation for travellers within Sleeping Units. It includes a hotel, motel, cabins, yurts or other semi-permanent tent Structures.

Tourist Facility means the use of Land, Buildings or Structures for facilities intended to attract and provide informational, social, recreational and entertainment experiences to visitors, but does not include Tourist Accommodation. It includes Accessory Uses of Eating Establishment and Retail Store.

Trellis means a Hard Landscape Structure, usually made from an open framework or lattice of interwoven or intersecting pieces of wood, bamboo, plastic or metal that is normally made to support and display vegetation.

Truck Terminal means a Building or Parcel used as an origin or destination point for the loading, unloading, assembling or transferring of goods transported by truck, or which provides containerized freight handling facilities or rail truck services, or where local pick-up, delivery and transitory storage of goods incidental to the principal function of the motor freight shipment is provided, or where trucks are repaired. Any Parcel where motor freight shipment is the Principal Use and where Vehicles in excess of single unit, single axle weights of 13,600 kg GVW (Gross Vehicle Weight) are operated, shall be considered, as a truck terminal.

Urban Agriculture means an Accessory Use consisting of the keeping of bees or hens or the cultivation of a portion of a Parcel for the production of food, including fruits, vegetables, nuts and herbs and not including livestock, for human consumption only.

Use means the purpose for which any Parcel, Land, Building, or Structure is used or occupied.

Utilities means development for utility infrastructure purposes that provides for Public Utilities or similar utilities where such utilities are established by the District, by another government body or by a company operating under the *Utilities Commission Act* and includes sewer, watermain, and power line easements, pump houses, substations, telephone exchanges, traffic, street lighting, traffic controls and Neighbourhood Energy Utility. This use does not include Storage Yards.

Vehicle means a Vehicle as defined in the *Motor Vehicle Act*.

Vehicle Service & Repair means the servicing and mechanical repair of automobiles, motorcycles, boats, snowmobiles, and similar Vehicles and small equipment or the sale, installation, or servicing of related accessories and parts. This includes but is not limited to transmission shops, muffler shops, small engine repairs, tire shops, auto glass shops, and upholstery shops and excludes Motor Vehicle Body Repair & Paint Shop.

Vehicle Body Repair & Paint Shop means those premises where automobiles, trucks, and other Vehicles undergo body repair and painting. This use specifically excludes the wrecking or storage of derelict Vehicles.

Vehicle Service Station means a business which provides light maintenance of Vehicles including the sale of Vehicle fuels, Electric Vehicle Charge Station, Vehicle Service & Repair, Vehicle Wash facilities, and the sale of

automotive fuels. It may include Eating Establishments, Retail Stores, and Recreational Vehicle Sanitary Dump Stations as Accessory Uses but excludes Vehicle Body Repair & Painting.

Vehicle Towing Service means a service in which two or more recovery Vehicles are employed in providing roadside assistance including the hauling, impound and sale of Vehicles, but excludes Scrap & Recycling Yard.

Vehicle Wash means a Building or Structure containing facilities for washing Vehicles, including tunnel car washers, coin operated automatic car washers, and coin operated self-service car washers.

Veterinary Clinic means any Building, Structure, or premises in which animals are treated for medical reasons, hospitalized or groomed.

Walkway means a Highway carrying pedestrian and non-motorized traffic only, except that a Walkway may be designed to afford emergency vehicle use.

Warehouse means the Commercial Use of Buildings and Structures for receiving and storage of goods and includes the storage of goods by a distributor or supplier who sells the goods at retail at other locations.

Waste Transfer Station means the use of premises for the receiving, Temporary storage, management and shipping of refuse and recyclables.

Wastewater Treatment Facility means a Municipal facility for the processing of wastewater from a Community Sewer System in accordance with the *Environmental Management Act* and related Regulations.

Water Treatment Facility means a Municipal facility for the production of drinking water for conveyance by a Community Water System in accordance with the *Drinking Water Protection Act* and related Regulations.

Watercourse means any natural or man-made drainage course or source of water, whether usually containing water or not, and includes any lake, river, creek, spring, ravine, swamp, gulch, or source of ground water, whether enclosed in a conduit or not, or as required by the Province of British Columbia.

Waterfront Parcel means a Parcel having a boundary in common with the Natural Boundary of Shuswap Lake, Mark Lake or the Eagle River.

Semi-Waterfront Parcel means a Parcel of Land that is only separated from the Natural Boundary of Shuswap Lake or Mara Lake by a rail line, rail trail or municipal Highway.

Wholesale means the use of Land, Buildings, or Structures, by establishments or businesses engaged in selling merchandise to retail dealers or to other wholesale dealers, or to contractors or to manufacturers, for resale or for use in their business.

Workshop means the use of wholly enclosed premises for the storing, maintenance, and assembly of equipment and material for audio, electrical, plumbing, construction, and related trades.

Works Yard means the use of a partially enclosed Building, or a portion thereof, or an open area of Land for the storing, repairing, or cleaning of supplies, materials, equipment, or Vehicles in support of off-site activities such as construction, installation, cleaning, repair or other services.

Wrecked Vehicle means a Vehicle that is not displaying a current licence decal for operation in British Columbia and that is not capable of operation under its own power.

Yard means an area between the Principal Building and relevant Parcel Line.

Front Yard means the area of a Parcel between the Side Parcel Lines extending from the Front Parcel Line to the nearest wall or supporting member of a Building or Structure.

Rear Yard means the area of a Parcel between the Side Parcel Lines extending from the Rear Parcel Line to the nearest wall or supporting member of a Building or Structure.

Side Yard means that part of the Parcel which extends from a Front Parcel Line to a Rear Parcel Line between the Side Parcel Line and the nearest wall or supporting member of a Building or Structure.

Zone means an area created by the Zoning Bylaw of the District of Sicamous as amended or as replaced from time to time before and after the effective date of this bylaw.

1.2 Other Definitions

Unless otherwise provided, terms shall have the same meaning as given by the *Community Charter*, the *Local Government Act*, the *Transportation Act*, the *Agricultural Land Commission Act*, the *Interpretation Act*, and other senior government legislation and regulations as apply.